

Skimmers

Keep pool water looking great!



Thru-the-Wall Hydro Skimmer Features/Benefits:

- **Thru-the-wall installation** for superior skimming action.
- **ABS Resin Lid** serves as a vacuum plate and is color-coordinated to match skimmer body.
- **Extra wide weir** to automatically keep surface free of insects and debris.
- **Patented automatic weir shut-off and relief valve combo** to prevent air suction and protect pump against damage from loss of prime.
- **Large basket** to collect debris while vacuuming.
- **Patented inside pool wall vacuum fitting** for maximum convenience and effectiveness.
- **U-gasket** to improve water tight installation.
- **Unitized construction of rust-proof, high impact ABS resin** for maximum durability.
- **1 1/2" skimmer hose fitting and 1 1/2" return hose fitting** for easy installation.



*Available in White, Tan, or Gray
to compliment the pool design*

Right Size!

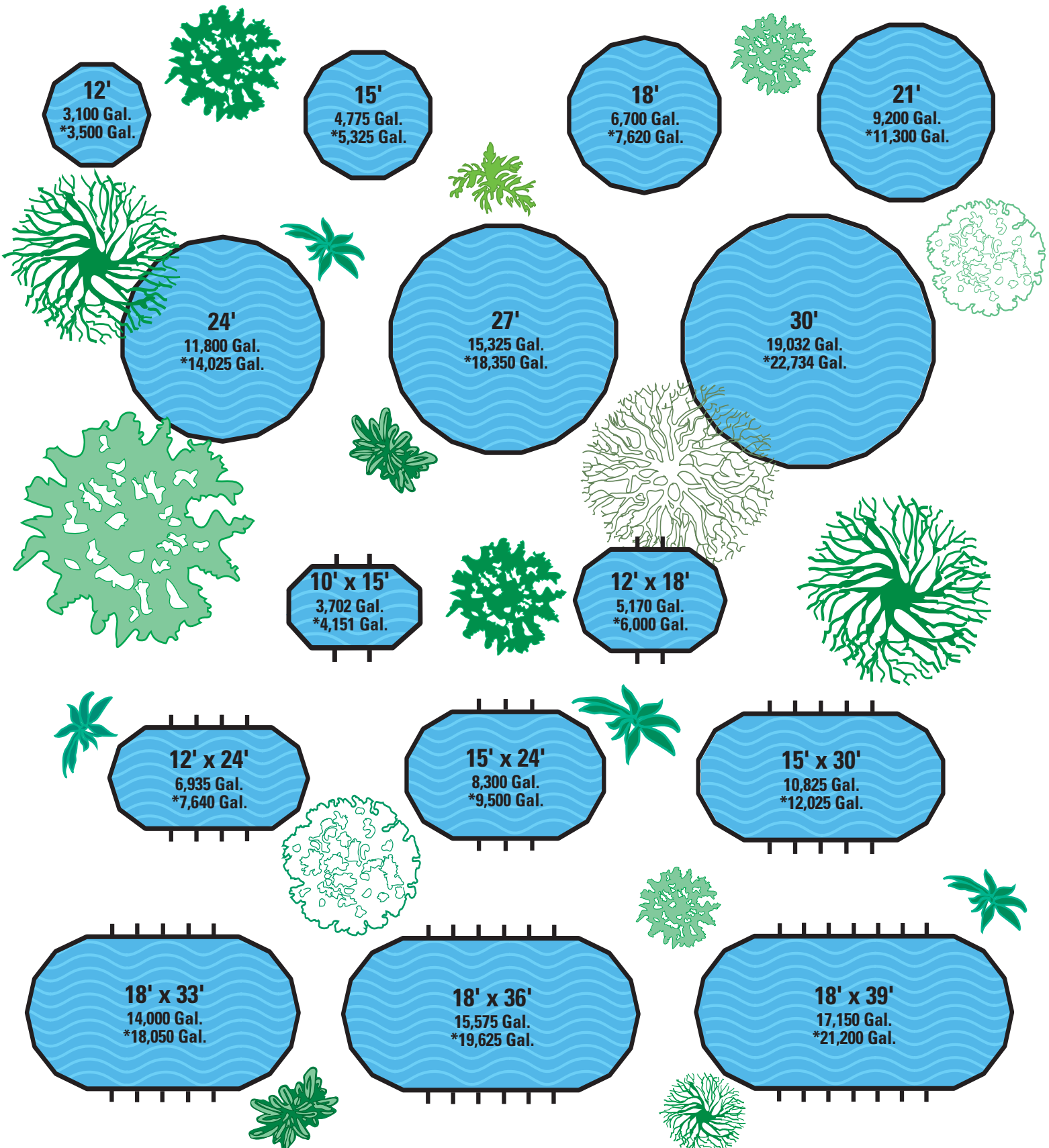

* Gallonage with variable depth liners. Note: Gallon capacities are for pools with 48" pool walls.



The Glider™

Automatic Pool Vacuum

An easy and efficient way to keep pools looking great!

The Glider™ is designed to clean any coved, flat bottom above-ground pool, or pools that feature an Optional Special-Purpose Deep Swimming Area for Underwater Swimming Only.

The Glider™ offers many outstanding features:

- ***Buoyancy Ring*** that keeps *The Glider™* at a proper angle for precise vacuuming.
- ***Durable Octagon-shaped Footpad***, in an attractive metallic-blue color; for positive pool movement.
- ***30 feet of Vacuum Hose*** for superior cleaning range.
- ***Swivel Device with Delrin® Washer*** to reduce friction and keep the hose from tangling.
- ***Universal Skimmer Fitting*** allows *The Glider™* to adapt to most pool skimmers.
- ***Customized Bumper*** for random-pattern cleaning coverage.
- ***Operates with pool filter.***
- ***Installs in minutes.***



Guardian[™]

Automatic In-Ground Pool Vacuum

*Provides an excellent way to
clean in-ground pools.*

*Its efficient design allows **Guardian**[™] to effortlessly clean a pool's deep areas, shallow areas, and most pool side walls. This unique pool cleaner truly gets the job done!*

Guardian[™] has many quality features:

- **45 feet of Vacuum Hose** to accommodate an average sized in-ground swimming pool.
- **Five (5) Hose Weights** allows **Guardian**[™] to easily access deep swimming areas of most in-ground pools.
- **Durable Round Footpad**, in a designer color, for positive movement inside of pool.
- **Buoyancy Ring** allows **Guardian**[™] to maintain the correct angle for effective vacuuming.
- **Custom Rub-bar** provides additional balance for the pool vacuum in deep water. This feature also allows **Guardian**[™] to pass by pool ladders or stairs which reduces the chance of the pool vacuum getting tangled or blocked during operation.
- **Swivel Device with Delrin[®] Washer** to reduce hose tangling and unnecessary friction.
- **Unique Bumper Design** allows for random-pattern cleaning coverage.
- **Universal Skimmer Fitting** allows **Guardian**[™] to adapt to most in-ground pool skimmers.
- **Easy to install.**
- **Operates with most pool filters.**

Safety Promotion Program

Promoting safe and correct use of CPP products.

Our comprehensive safety promotion program has become a standard for the entire above-ground pool industry. It is very important to advise your customers of proper pool safety. Also, be sure to set a good example for your customers by placing all safety decals and signage in the appropriate locations on all of your display pools.

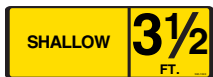

Shallow 3 1/2 Feet decal

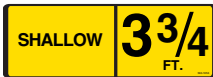

Shallow 3 3/4 Feet decal



"Warning — No Diving" decal



Connector Warning decal

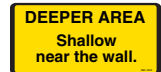

Deeper Area decal. For pools with an excavated Optional Special-Purpose Deep Swimming Area.



"Warning — No Diving/Prevent Drowning" pool sign. A 16" x 19 1/4" durable, weather-resistant pool "warning" sign with international safety symbols. The Consumer Product Safety Commission recommends the use of this sign with all residential swimming pools.

In addition, manufacturing applies a pressure-sensitive version of this sign

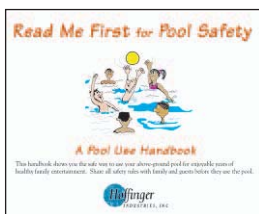

"Safety First Pool Use Handbook." A colorful booklet that gives a new pool owner guidelines for safe and correct use of a above-ground pool, general pool maintenance, and recommendations on the placement of their safety material.

Pool Safety Video. This 12-14 minute, full-color video offers valuable guidelines on proper pool usage.

Get the Advantage!



For 60 years, the CPP name has stood for high quality, yet affordable pool products. We began as filtration specialists and have subsequently become an integral part of the world's leading above-ground pool manufacturer. To begin with, all CPP products are proudly Manufactured in the U.S.A. to ensure exceptional quality. In addition, our 660,000 sq. ft. manufacturing facility allows us to monitor the production of our above-ground pools, filtration systems, skimmers, and other pool products in order to assure maximum efficiency and product excellence.

What's more, by being a reliable supplier with a proven track record for superior products, CPP can offer your customers everything they need to experience the best in backyard fun and recreation. We've maintained this tradition for over half a century and we plan to continue the unsurpassed service!

Compare the CPP Advantage!



The CPP Advantage means a variety of affordable above-ground pools designed to fit every backyard and every budget. After all, a CPP pool—always an excellent value—is your most complete family fun package, engineered to exacting standards for quality, reliability, and long life. But don't just take our word for it. Compare CPP's exciting features and benefits with those of the competition and you'll soon see why CPP is your best choice for above-ground swimming pools and pool products.



Wall & Frame Features

- Rugged Hot-dipped Galvanized Copper Bearing Steel Pool Wall & Frame** for maximum strength, durability, and corrosion resistance.
- Multipart treatments with protective coatings**—which include Tuff-Kote™ Zinc Protective Coating, Poly-Lam™ Texture Coating, and Double-Kote™ Baked Enamel Finish—for long product life. Available on most models.
- Heavyweight Pool Construction makes Lomart pools up to 25% heavier than most other pools in the industry!** Our state-of-the-art manufacturing techniques, and extremely rugged pool components, combine perfectly for pools built to last a lifetime.
- Up to 20% More Upright Verticals** than most other pools in the industry to provide optimum pool stability.
- Large assortment of round and oval sizes** to accommodate any sized backyard.
- Textured Resin Top Connectors** offer a sleek, corrosion-resistant, one-piece enclosure of the top rail without seams or exposed screws.
- Streamlined Structural Design** enhances pool strength and allows for an easy, efficient installation.
- Tru-Lock™ Wall Closure** offers a newly-designed fastening system for maximum strength, greater wall stability, and a faster, easier assembly.
- Trimline Space Saver™ Oval Support System** features an easy-to-install, one-part design which provides a stronger installation and a more attractive appearance. Allows larger pools to fit into smaller backyard settings.

Liner Features

- Heavyweight Pool Liners**—heavier than most liners in the industry—premium liners are manufactured with **Full 20 Mil Material** on both the sidewall and pool bottom—liners that are designed to last.
- Special Manufacturing Process**, using natural raw materials and ultraviolet ray inhibitors, gives Lomart complete control over the top-quality vinyl used to create our liners.
- Choice of beautiful patterned liners or solid blue liners** to match your style and backyard decor.
- Variable Depth Liners**, featuring additional surface area of our rugged sidewall vinyl, allow for an Optional Special-Purpose Deep Swimming Area for Underwater Swimming Only.

Other Advantages

- A Full Line of Above-Ground Pool Products** including filters, skimmers, pool ladders, automatic pool cleaners, and much more.
- Custom, Thru-the-wall Hydro Skimmer**, constructed of high-impact ABS resins, features an extra-large skimmer opening for superb skimming action. Easy-to-use design keeps pool water looking great. Available in white, tan, or gray.
- Pool Safety Program** to promote the safe and correct use of above-ground pools.
- Made in the USA with over 55 years of manufacturing experience**, at our 660,000 sq. ft. plant in West Helena, Arkansas, to ensure quality craftsmanship.
- Generous Warranties** to assure product excellence.

Conventional Oval Support System

Conventional oval side supports require more space to install, more blocks or concrete pads, and are much more labor intensive to assemble.

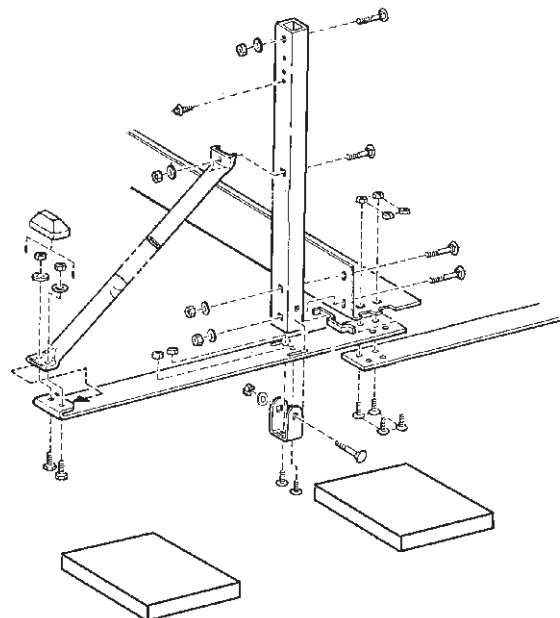

Conventional Oval Supports Vs. Trimline Space Saver™ Oval Supports

Trimline Space Saver™ Oval Support System

With the Trimline Space Saver™ Oval Support System, larger pool models can be installed in the same pool area. A 12' wide oval with the Trimline support only requires 13.5 feet compared to the 18 feet needed for a conventional support. The customer saves 4.5 feet of their yard space, giving them the option to select a larger Lomart oval pool!



Trimline Space Saver™ Oval Support System Benefits:

- **One-part design;** the Trimline support is a part of the side vertical for a more efficient pool installation.
- **Less parts allow for a stronger assembly.**
- **Only 9" of support is exposed** for a more attractive appearance
- **Stylish tapered support design.** No unsightly Hold Down Plates, Buttress Diagonals, or Diagonal Caps.
- **Much easier to install** than a conventional side support; takes half the time.
- **Only one cinder block or concrete pad per vertical** needed for installation, compared to two blocks or pads required for conventional oval support.
- **Trimline supports are more cost effective and require less labor for installation.**

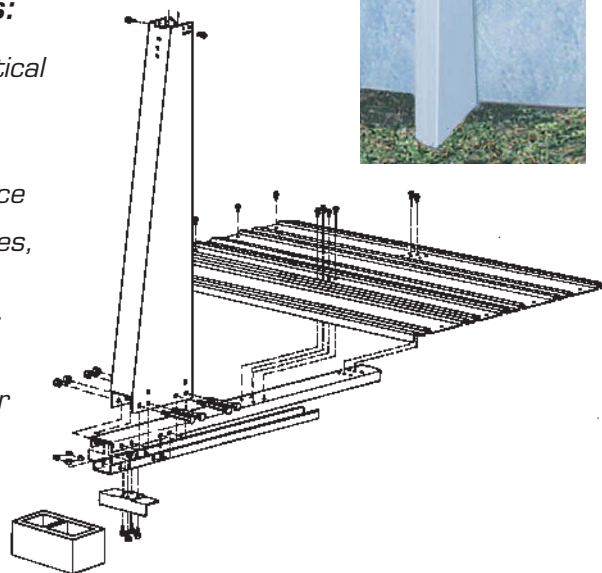

Dare to Compare

There are many choices in today's above-ground pool market . CPP pools are among the best in the industry and we would like to prove it to you. Read over our facts and Dare to Compare us with our competitors! We are confident you'll agree – CPP is your best choice for above-ground swimming pools.

Heavier Pool Walls. Fact: CPP Walls are made from heavier Copper Bearing Steel than industry standards — 30 to 60 pounds heavier for superior strength.

More Vertical Supports. Fact: CPP Pools have as many as 20% more vertical supports than other brands to ensure stability during heavy family use or the coldest of winters.

Trimline Oval Supports. Fact: CPP Oval Supports extend only 9 inches beyond the sidewall, not the standard 36 inches. This allows a CPP 18-foot wide pool to be installed in the same space as another brand's 15-foot wide pool.

Precision Frame Holes. Fact: CPP Pools are built with strength throughout, right down to the vertical end caps holes that allow for precision-fit construction. Other brands use the cheaper, easier to produce slotted holes that weaken the pools structural integrity. Shake a Lomart pool and you'll know it's well built!

Family Safety Program. Fact: CPP is committed to pools safety! Our safety handbook, liner decals, video and signage, recommended by the US Consumer Products Safety Commission, are included with every pool!

Deep Swim Area Pools. Fact: CPP Variable Depth Liners expand to more than 72 inches deep for a large underwater swimming area, while competitors raise their pool walls to 54 inches above ground reducing or eliminating parental visual safety observation.

No Stainless Panel. Fact: CPP Pools unique design protects the pool wall from leakage and damage. Using a special skimmer U-gasket and advanced wall coatings, CPP eliminates dangerous effect of "Dissimilar Metal Corrosion" which is caused by incorporating stainless steel panels with galvanized steel pool walls. Over time this will cause the wall at the two connection points to rust away and lead to pool failure. Our designs ensures structural integrity and beauty throughout the CPP pool line.